

**FLOOR PLAN**  
 SCALE: NTS  
 ARCH REF: 1/A101

**01**

**GROUND LEVEL**  
 YKK YHS 50-FI ALUMINUM IMPACT STOREFRONT SYSTEM  
 YKK 35H MEDIUM STILE IMPACT ENTRANCE DOORS  
 CR LAURENCE D2307A TRANSACTION WINDOW  
 INTERIOR MISCELLANEOUS GLASS

NO.	DATE	BY	DESCRIPTION
1	06/20/22	fp	First Submittal

**EVINS GLASS SERVICE, INC**  
 101 N.P.I.D., CORPUS CHRISTI, TX 78406  
 WORK (361) 884-3995 FAX (361) 884-4262

PROJECT: SECURITY SERVICE FEDERAL CREDIT UNION  
**NEW BUILDING WITH TENANT SPACES**  
 ARCHITECT: LUNA MIDDLEMAN ARCHITECTS  
 (210) 346-2400  
 GENERAL CONTRACTOR: JORDAN FOSTER CONSTRUCTION  
 (210) 375-1280

PROJECT NO.	EGS-2206-01
DRAWN BY	fp
DATE	06/20/22
SCALE	NTS
DRAWING	FLOOR PLANS
SHEET	P1

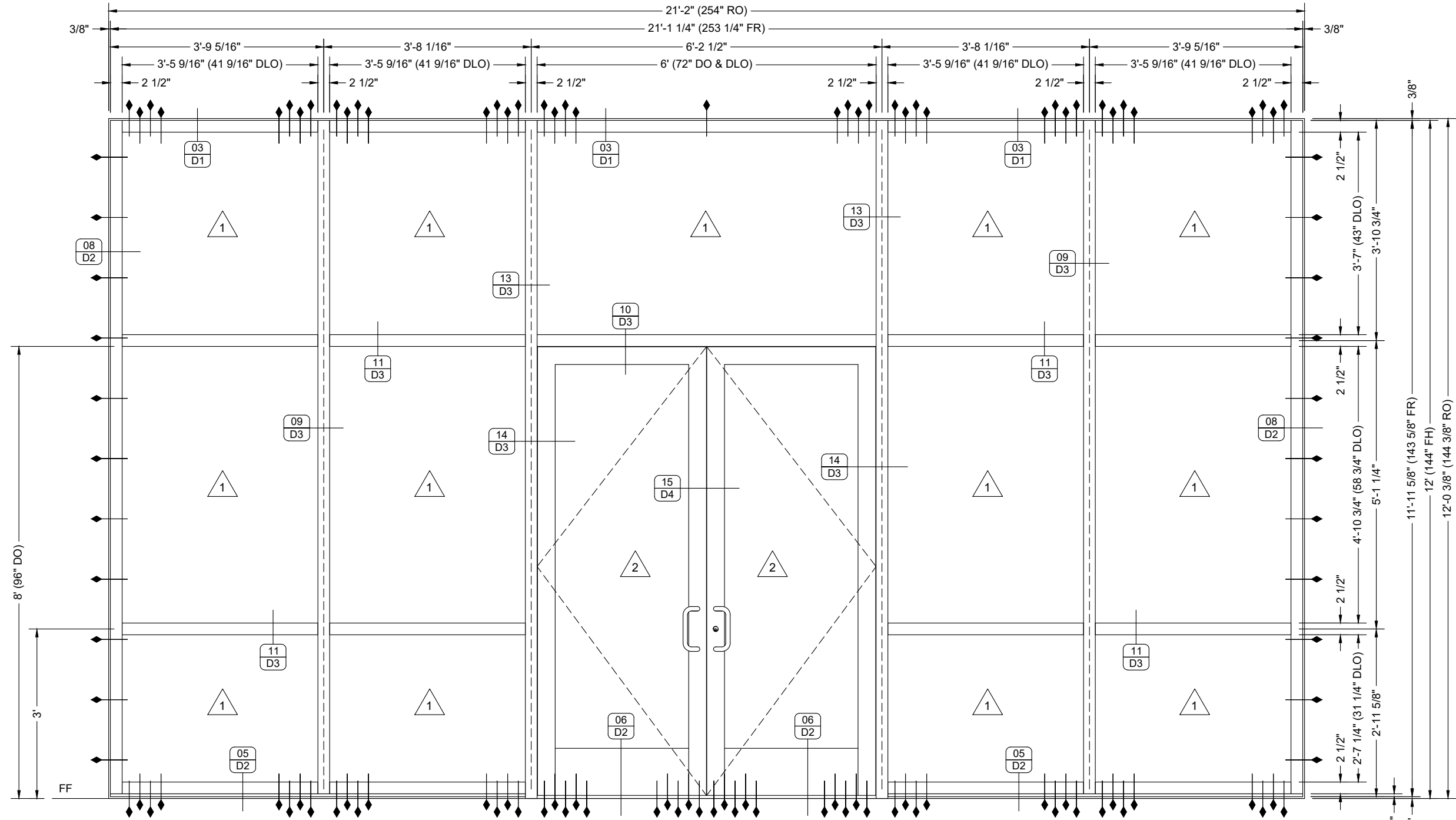

**ELEVATION**

QUANTITY: 01  
 SCALE: 1/2" = 1'-0"  
 ARCH REF: 1/A101  
 1/A201  
 1/A210 3/A501 3/A601 13/A602 15/A602 17/A602 18/A602 19/A602



**EXT STOREFRONT**

YKK YHS 50-FI IMPACT ALUMINUM STOREFRONT  
 YKK 35H MEDIUM STILE IMPACT DOORS

**DOOR HARDWARE**

- YKK H-6104 Standard Surface Mounted Closer
- YKK P-1300 Standard 4 1/2" x 4" Butt Hinges
- YKK P-52497 Standard Concealed Vertical Rod Panic Exit Device
- YKK H-1341/1541/1542 Standard Smart Series Entrance Handles
- YKK H-7107 10" Bottom Rail Weatherstrip with Gasket and Door Sweep
- YKK H-8101/8201/8301 Series Standard 1/2" x 4" Thresholds
- DUAL Horton 7100 Commercial Series Auto Operators (power by others)

DATE	DESCRIPTION
06/20/22	First Submittal
fp	BY
1	SUB

**EVINS GLASS SERVICE, INC**  
 101 N.P.I.D., CORPUS CHRISTI, TX 78406  
 WORK (361) 884-3995 FAX (361) 884-4262

PROJECT SECURITY SERVICE FEDERAL CREDIT UNION  
**NEW BUILDING WITH TENANT SPACES**  
 ARCHITECT LUNA MIDDLEMAN ARCHITECTS  
 (210) 340-2400  
 GENERAL CONTRACTOR JORDAN FOSTER CONSTRUCTION  
 (210) 375-1280

PROJECT NO. <b>EGS-2206-01</b>	
DRAWN BY <b>fp</b>	DATE <b>06/20/22</b>
SCALE 1/2" = 1'-0"	
DRAWING <b>ELEVATIONS</b>	
SHEET <b>E1</b>	

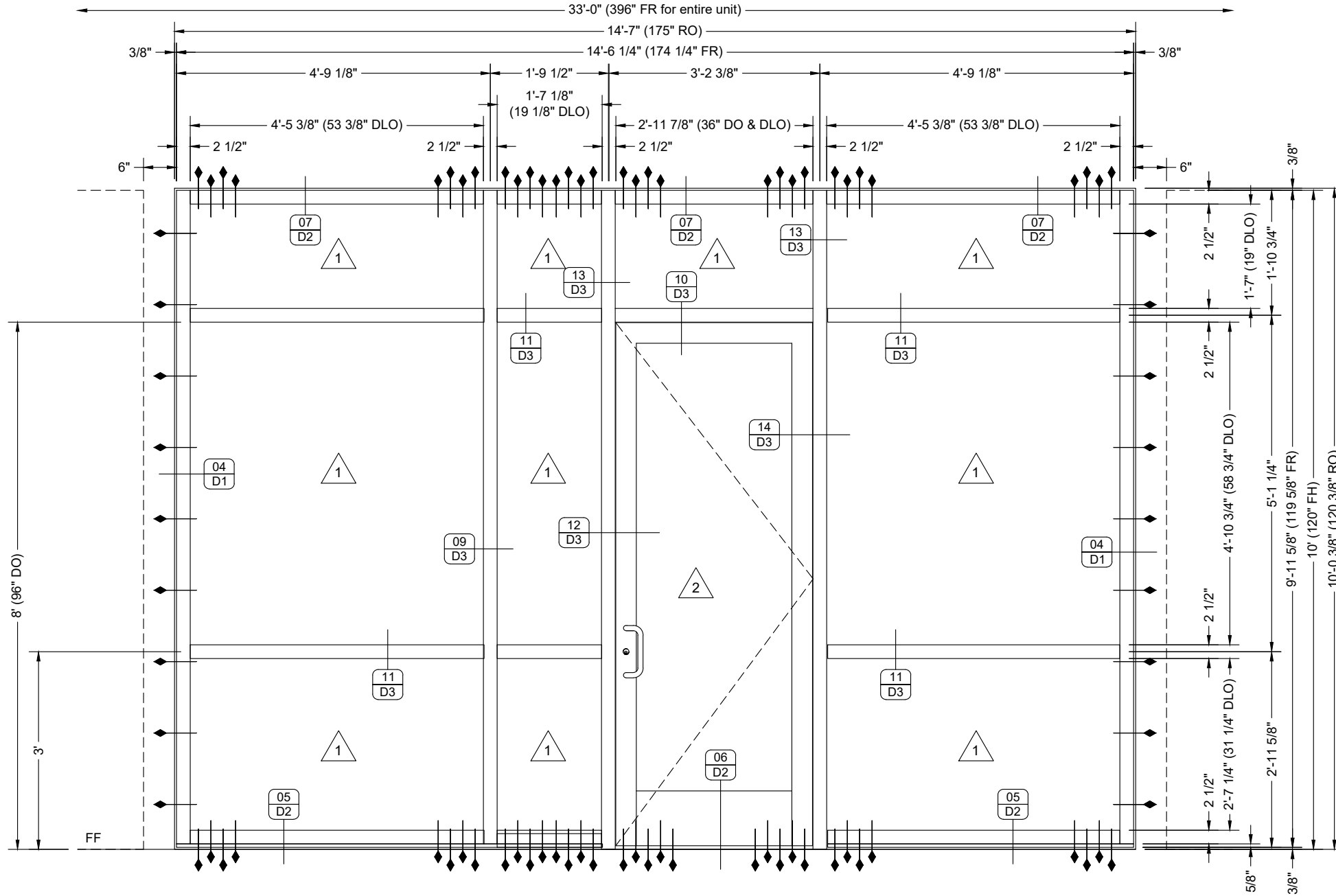

**ELEVATION**

QUANTITY: 01  
 SCALE: 1/2" = 1'-0"  
 ARCH REF: 1/A101  
 1/A201  
 3/A501 3/A601 15/A602 17/A602 18/A602

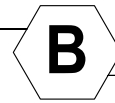

**EXT STOREFRONT**

YKK YHS 50-FI IMPACT ALUMINUM STOREFRONT  
 YKK 35H MEDIUM STILE IMPACT DOORS

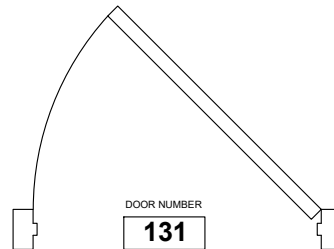

**DOOR HARDWARE**

- YKK H-6104 Standard Surface Mounted Closer
- YKK P-1300 Standard 4 1/2" x 4" Butt Hinges
- YKK P-52497 Standard Concealed Vertical Rod Panic Exit Device
- YKK H-1341/1541/1542 Standard Smart Series Entrance Handles
- YKK H-7107 10" Bottom Rail Weatherstrip with Gasket and Door Sweep
- YKK H-8101/8201/8301 Series Standard 1/2" x 4" Thresholds
- DUAL Horton 7100 Commercial Series Auto Operators (power by others)

DATE	BY	DESCRIPTION
06/20/22	fp	First Submittal

**EVINS GLASS SERVICE, INC**  
 101 N.P.I.D., CORPUS CHRISTI, TX 78406  
 WORK (361) 884-3995 FAX (361) 884-4262

PROJECT SECURITY SERVICE FEDERAL CREDIT UNION  
**NEW BUILDING WITH TENANT SPACES**  
 ARCHITECT LUNA MIDDLEMAN ARCHITECTS  
 (210) 340-2400  
 GENERAL CONTRACTOR JORDAN FOSTER CONSTRUCTION  
 (210) 375-1280

PROJECT NO.	EGS-2206-01
DRAWN BY	fp
DATE	06/20/22
SCALE	1/2" = 1'-0"
DRAWING	ELEVATIONS
SHEET	E2

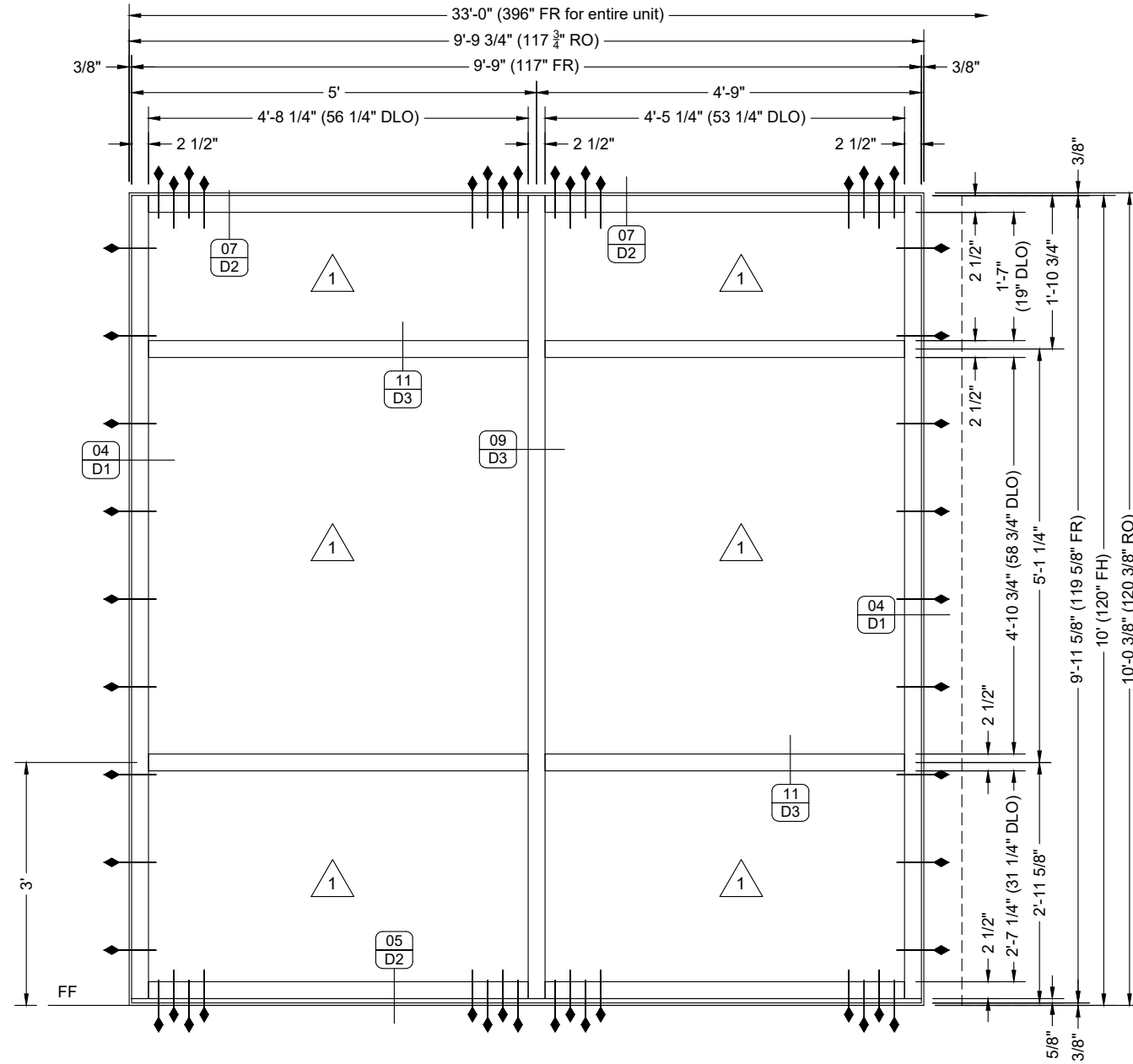

**ELEVATION**

QUANTITY: 01  
 SCALE: 1/2" = 1'-0"  
 ARCH REF: 1/A101  
 1/A201  
 3/A501 3/A601 15/A602 17/A602 18/A602

**B1**

**EXT STOREFRONT**

YKK YHS 50-FI IMPACT ALUMINUM STOREFRONT  
 YKK 35H MEDIUM STILE IMPACT DOORS

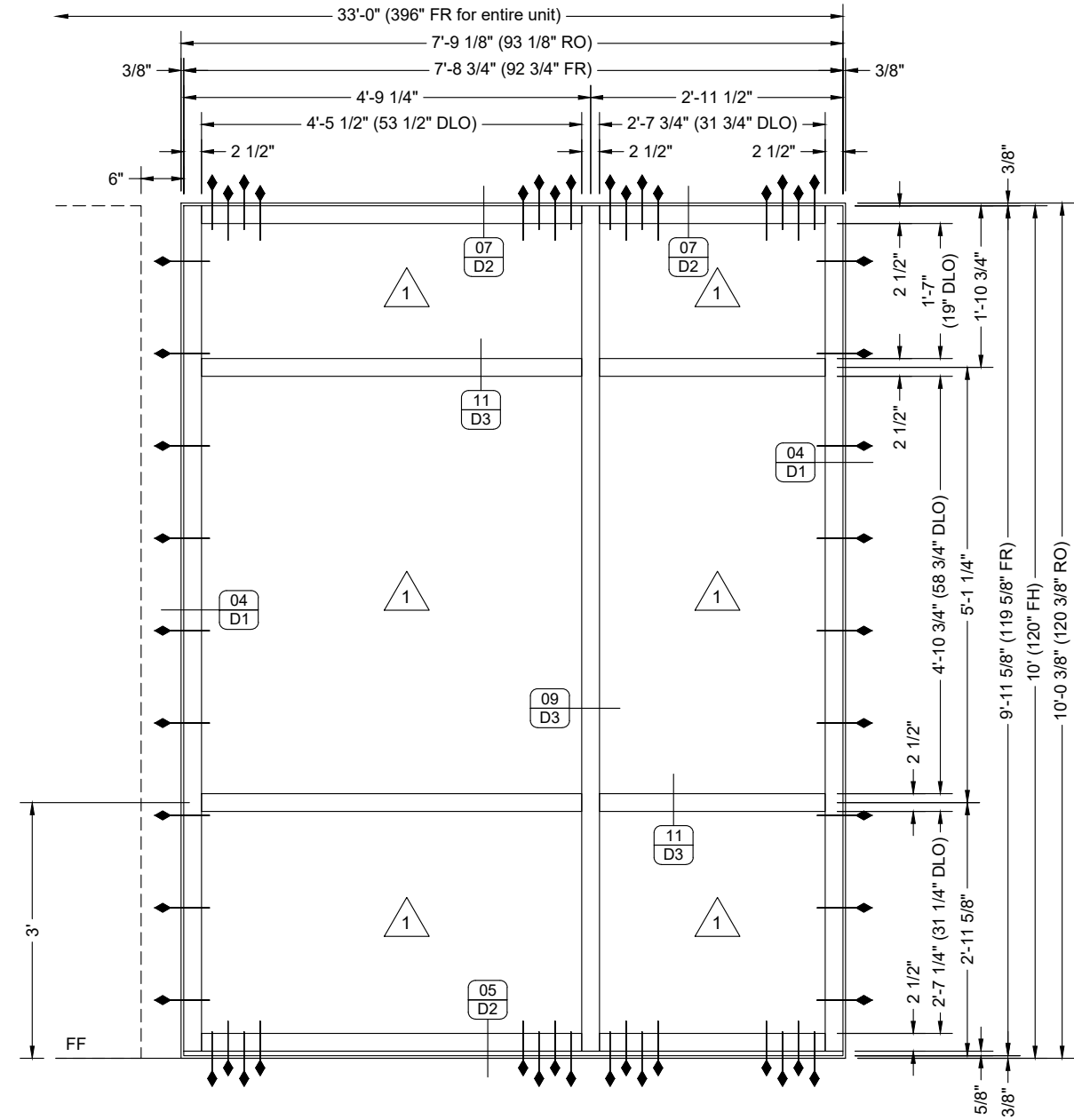

**ELEVATION**

QUANTITY: 01  
 SCALE: 1/2" = 1'-0"  
 ARCH REF: 1/A101  
 1/A201  
 3/A501 3/A601 15/A602 17/A602 18/A602

**B2**

**EXT STOREFRONT**

YKK YHS 50-FI IMPACT ALUMINUM STOREFRONT  
 YKK 35H MEDIUM STILE IMPACT DOORS

NO.	SUB	BY	DATE	DESCRIPTION
1	fp		06/20/22	First Submittal

**EVINS GLASS SERVICE, INC**

101 N.P.I.D., CORPUS CHRISTI, TX 78406  
 WORK (361) 884-3995 FAX (361) 884-4262

PROJECT SECURITY SERVICE FEDERAL CREDIT UNION  
**NEW BUILDING WITH TENANT SPACES**

ARCHITECT LUNA MIDDLEMAN ARCHITECTS  
 (210) 346-2400  
 GENERAL CONTRACTOR JORDAN FOSTER CONSTRUCTION  
 (210) 375-1280

PROJECT NO. EGS-2206-01

DRAWN BY fp DATE 06/20/22

SCALE 1/2" = 1'-0"

DRAWING ELEVATIONS

SHEET E3

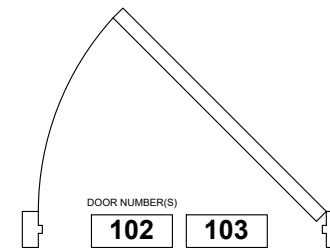
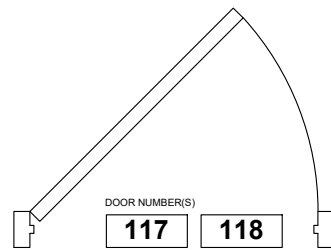
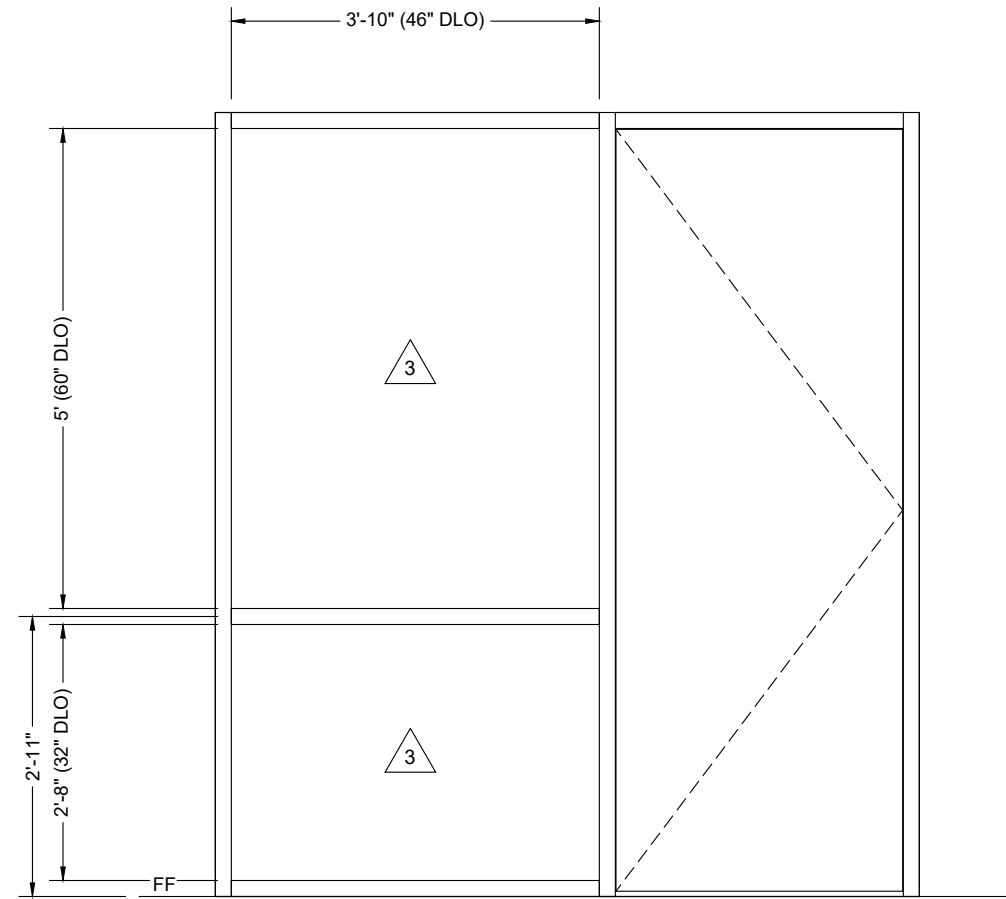
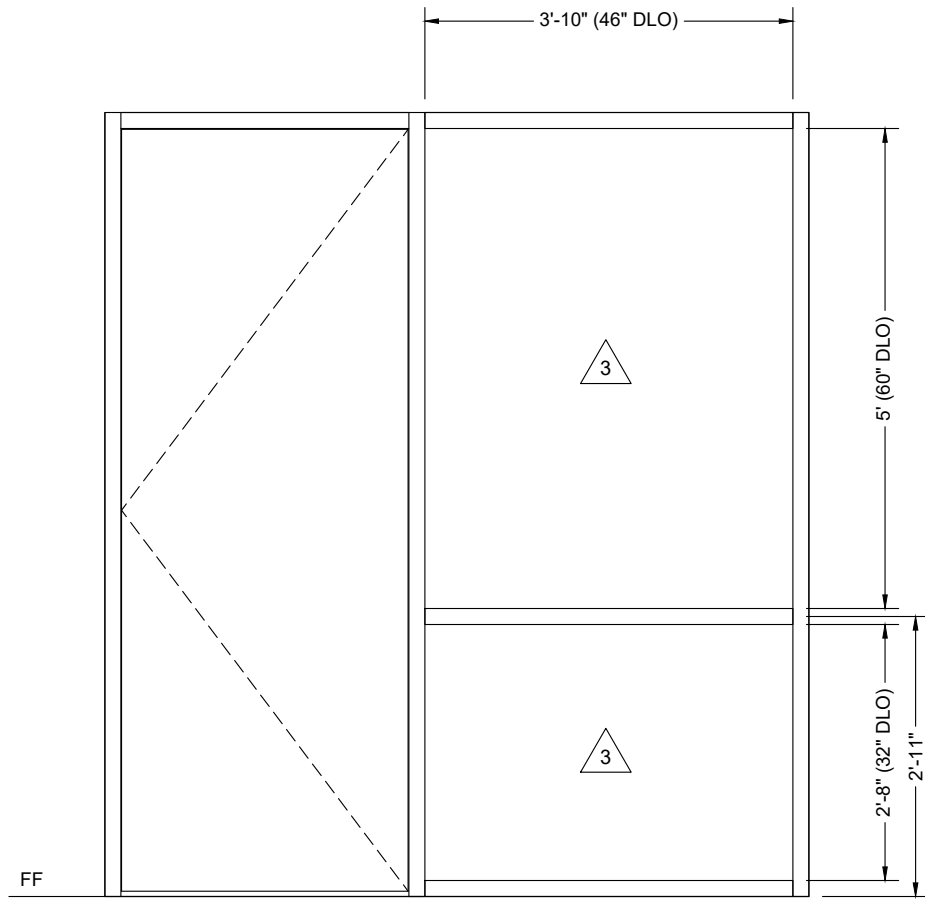

**ELEVATION**

QUANTITY: 02  
 SCALE: 1/2" = 1'-0"  
 ARCH REF: 1/A101  
 3/A601



**EXT STOREFRONT**

GLASS ONLY  
 DOOR AND FRAME BY OTHERS

**ELEVATION**

QUANTITY: 02  
 SCALE: 1/2" = 1'-0"  
 ARCH REF: 1/A101  
 3/A601



**EXT STOREFRONT**

GLASS ONLY  
 DOOR AND FRAME BY OTHERS

DATE	DESCRIPTION
06/20/22	First Submittal
fp	BY
1	SUB

**EVINS GLASS SERVICE, INC**  
 101 N.P.I.D., CORPUS CHRISTI, TX 78406  
 WORK (361) 884-3995 FAX (361) 884-4262

PROJECT SECURITY SERVICE FEDERAL CREDIT UNION  
**NEW BUILDING WITH TENANT SPACES**  
 ARCHITECT LUNA MIDDLEMAN ARCHITECTS  
 (210) 340-2400  
 GENERAL CONTRACTOR JORDAN FOSTER CONSTRUCTION  
 (210) 375-1280

PROJECT NO.	EGS-2206-01
DRAWN BY	fp
DATE	06/20/22
SCALE	1/2" = 1'-0"
DRAWING	ELEVATIONS
SHEET	E4

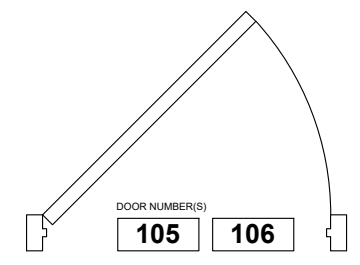
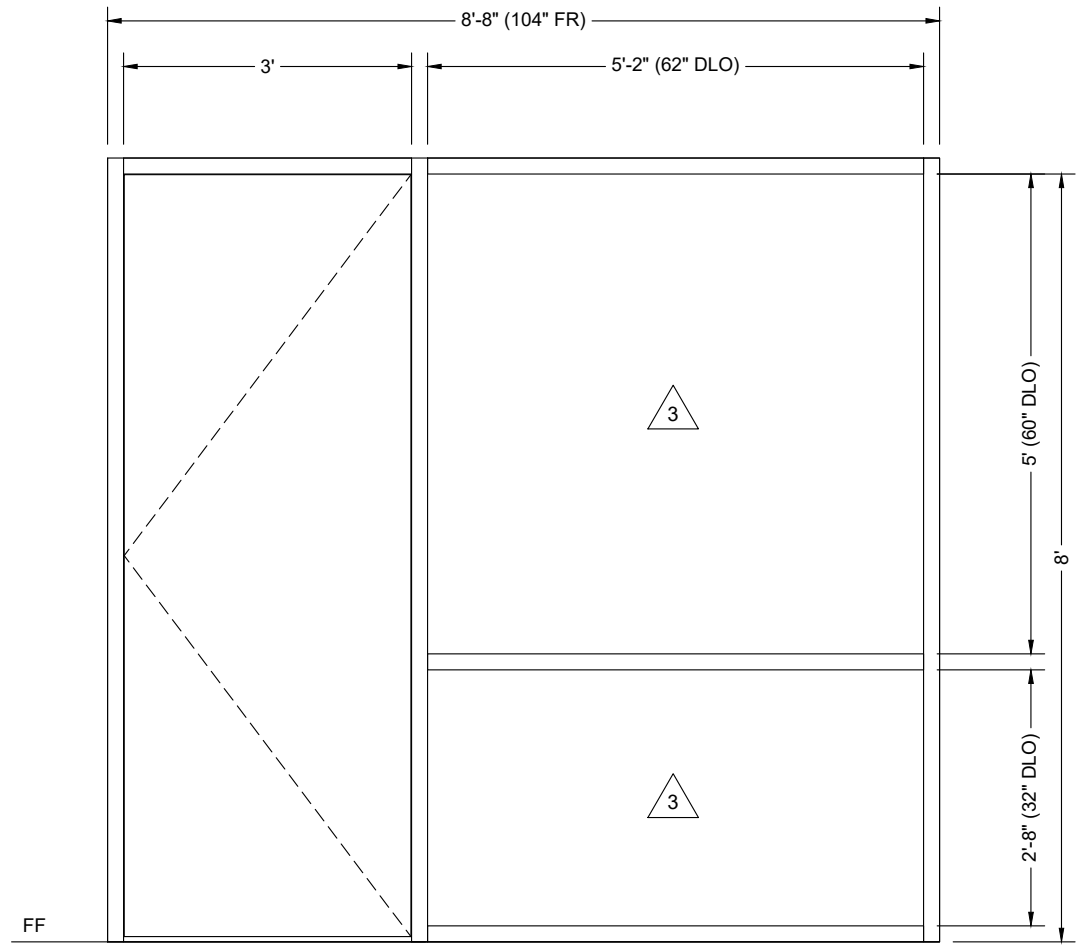

**ELEVATION**

QUANTITY: 02  
 SCALE: 1/2" = 1'-0"  
 ARCH REF: 1/A101  
 3/A601

**DL** EXT STOREFRONT

GLASS ONLY  
 DOOR AND FRAME BY OTHERS

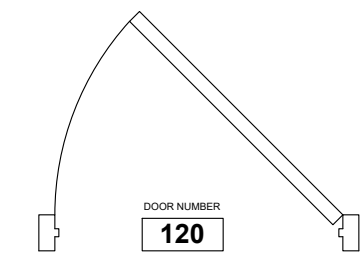
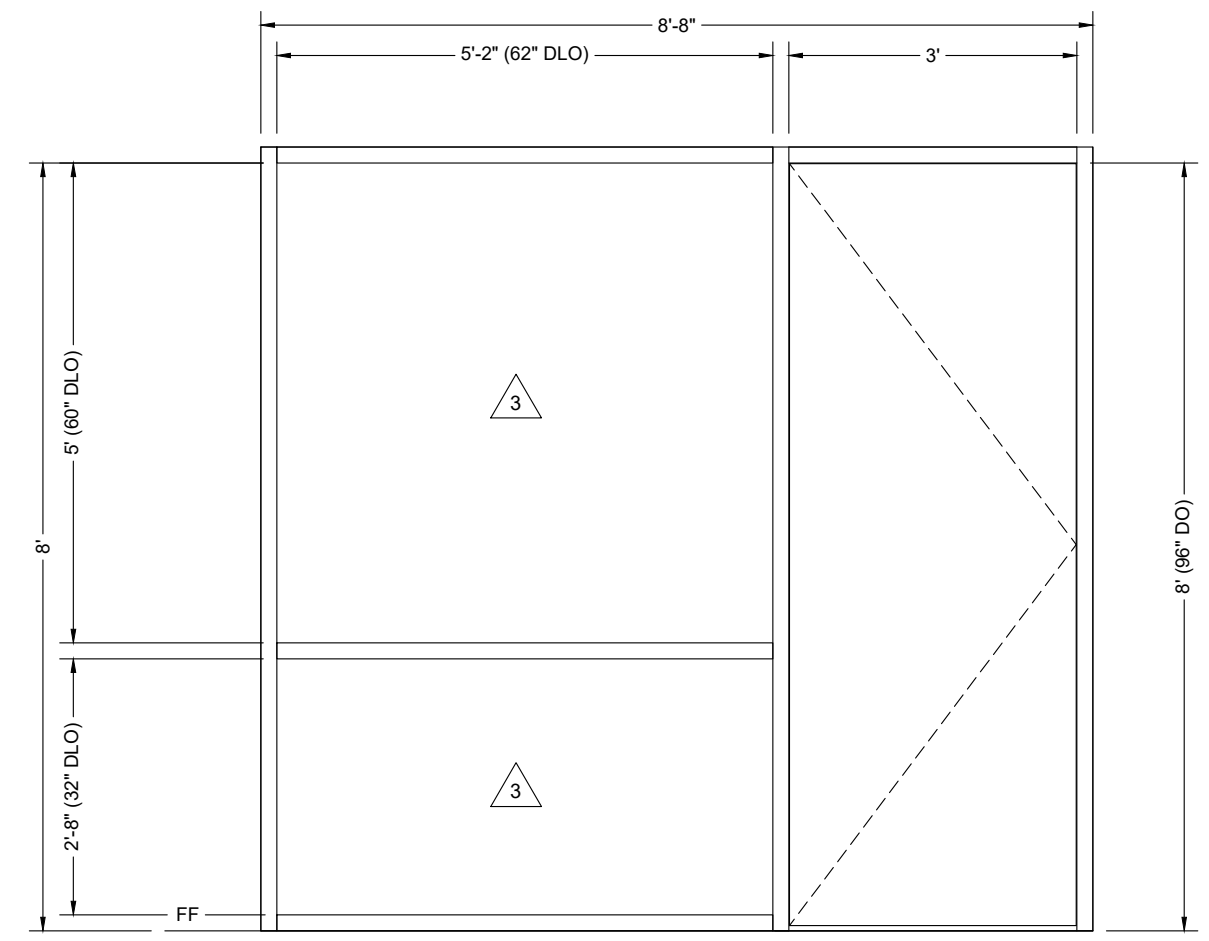

**ELEVATION**

QUANTITY: 01  
 SCALE: 1/2" = 1'-0"  
 ARCH REF: 1/A101  
 3/A601

**DR** EXT STOREFRONT

GLASS ONLY  
 DOOR AND FRAME BY OTHERS

NO.	DATE	BY	DESCRIPTION
1	06/20/22	fp	First Submittal

**EVINS GLASS SERVICE, INC**  
 101 N.P.I.D., CORPUS CHRISTI, TX 78406  
 WORK (361) 884-3995 FAX (361) 884-4262

PROJECT SECURITY SERVICE FEDERAL CREDIT UNION  
**NEW BUILDING WITH TENANT SPACES**  
 ARCHITECT LUNA MIDDLEMAN ARCHITECTS  
 (210) 340-2400  
 GENERAL CONTRACTOR JORDAN FOSTER CONSTRUCTION  
 (210) 375-1280

PROJECT NO.	EGS-2206-01
DRAWN BY	fp
DATE	06/20/22
SCALE	1/2" = 1'-0"
DRAWING	ELEVATIONS
SHEET	E5

NO.	DATE	DESCRIPTION
1	06/20/22	First Submittal
1	fp	BY
1		SUB

**EVINS GLASS SERVICE, INC**  
 101 N.P.I.D., CORPUS CHRISTI, TX 78406  
 WORK (361) 884-3995 FAX (361) 884-4262

PROJECT SECURITY SERVICE FEDERAL CREDIT UNION  
**NEW BUILDING WITH TENANT SPACES**  
 ARCHITECT LUNA MIDDLEMAN ARCHITECTS  
 (210) 340-2400  
 GENERAL CONTRACTOR JORDAN FOSTER CONSTRUCTION  
 (210) 375-1280

PROJECT NO.	EGS-2206-01
DRAWN BY	fp
DATE	06/20/22
SCALE	1/2" = 1'-0"
DRAWING	ELEVATIONS
SHEET	E6

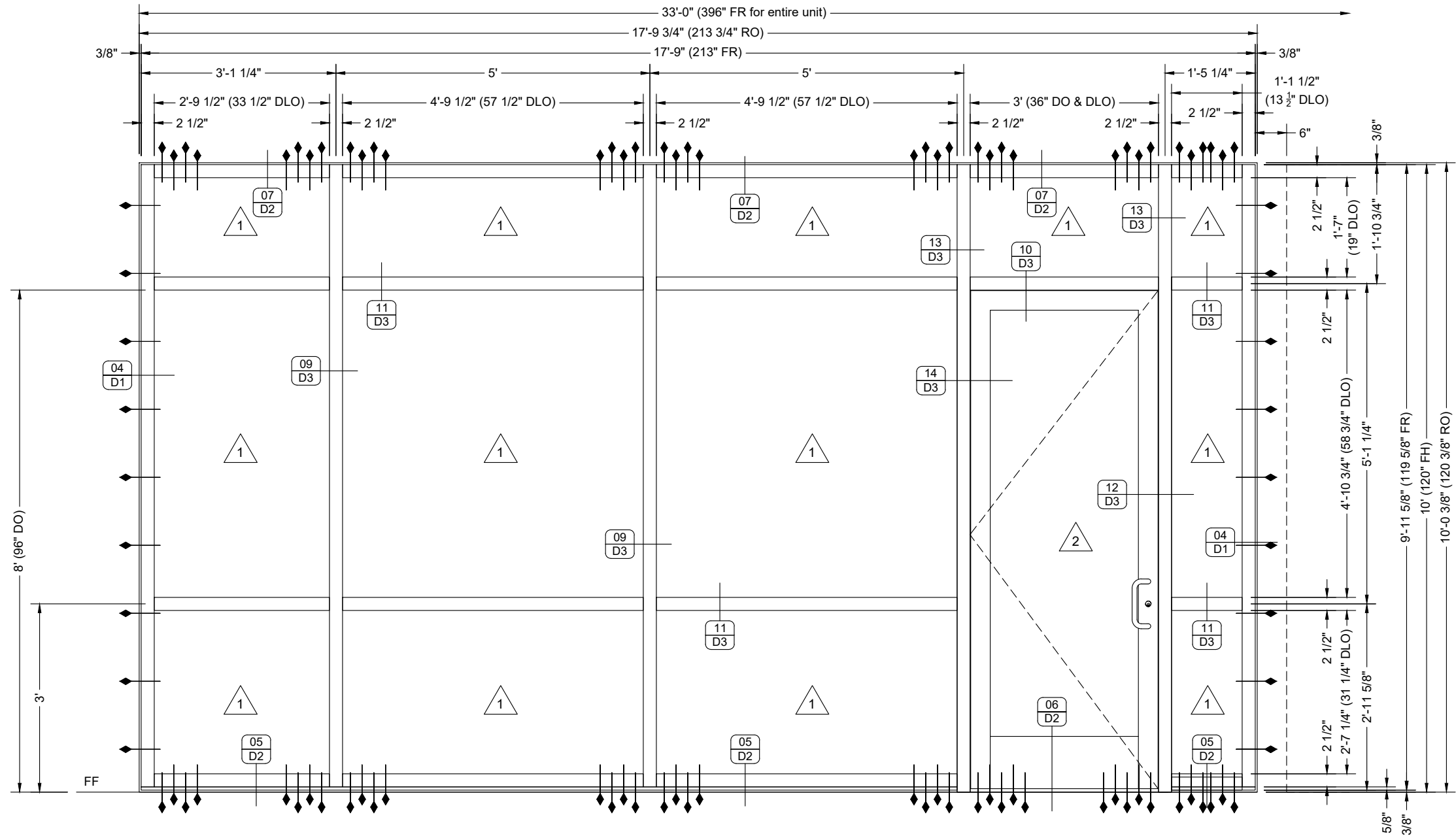

**ELEVATION**

QUANTITY: 01  
 SCALE: 1/2" = 1'-0"  
 ARCH REF: 1/A101  
 3/A601  
 10/A701



**EXT STOREFRONT**

YKK YHS 50-FI IMPACT ALUMINUM STOREFRONT  
 YKK 35H MEDIUM STILE IMPACT DOORS

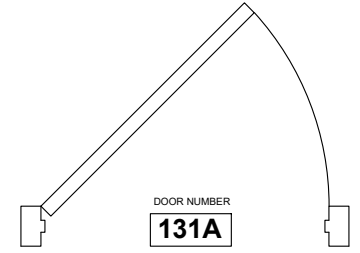

**DOOR HARDWARE**

- YKK H-6104 Standard Surface Mounted Closer
- YKK P-1300 Standard 4 1/2" x 4" Butt Hinges
- YKK P-52497 Standard Concealed Vertical Rod Panic Exit Device
- YKK H-1341/1541/1542 Standard Smart Series Entrance Handles
- YKK H-7107 10" Bottom Rail Weatherstrip with Gasket and Door Sweep
- YKK H-8101/8201/8301 Series Standard 1/2" x 4" Thresholds
- DUAL Horton 7100 Commercial Series Auto Operators (power by others)

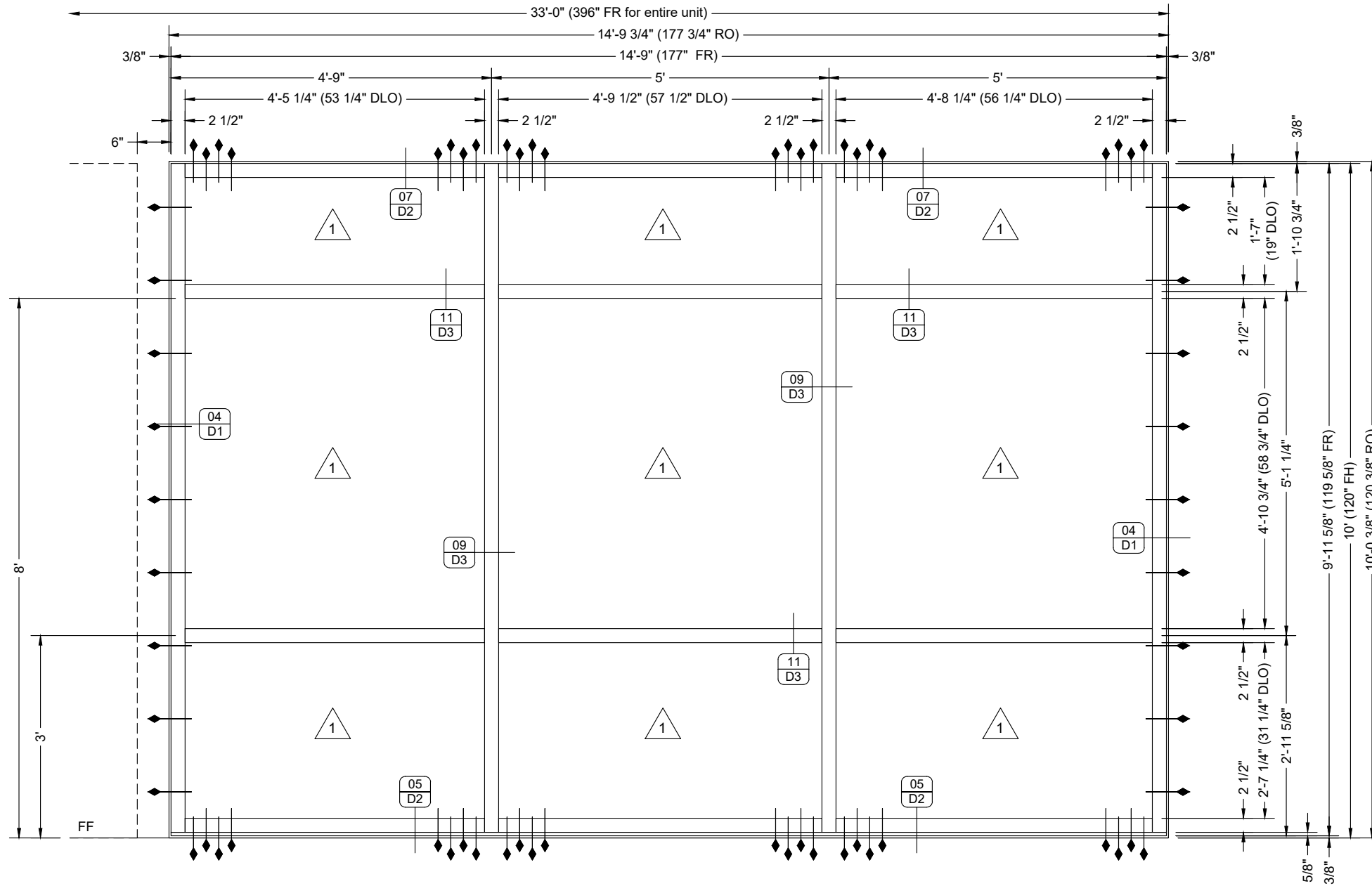

**ELEVATION**

QUANTITY: 01  
 SCALE: 1/2" = 1'-0"  
 ARCH REF: 1/A101  
 3/A601  
 10/A701



**EXT STOREFRONT**

YKK YHS 50-FI IMPACT ALUMINUM STOREFRONT

SUB	BY	DATE	DESCRIPTION
1	fp	06/20/22	First Submittal

**EVINS GLASS SERVICE, INC**  
 101 N.P.I.D., CORPUS CHRISTI, TX 78406  
 WORK (361) 884-3995 FAX (361) 884-4262

PROJECT SECURITY SERVICE FEDERAL CREDIT UNION  
**NEW BUILDING WITH TENANT SPACES**  
 ARCHITECT LUNA MIDDLEMAN ARCHITECTS  
 (210) 346-2400  
 GENERAL CONTRACTOR JORDAN FOSTER CONSTRUCTION  
 (210) 375-1260

PROJECT NO.		EGS-2206-01
DRAWN BY	DATE	
fp	06/20/22	
SCALE		1/2" = 1'-0"
DRAWING		ELEVATIONS
SHEET		E7



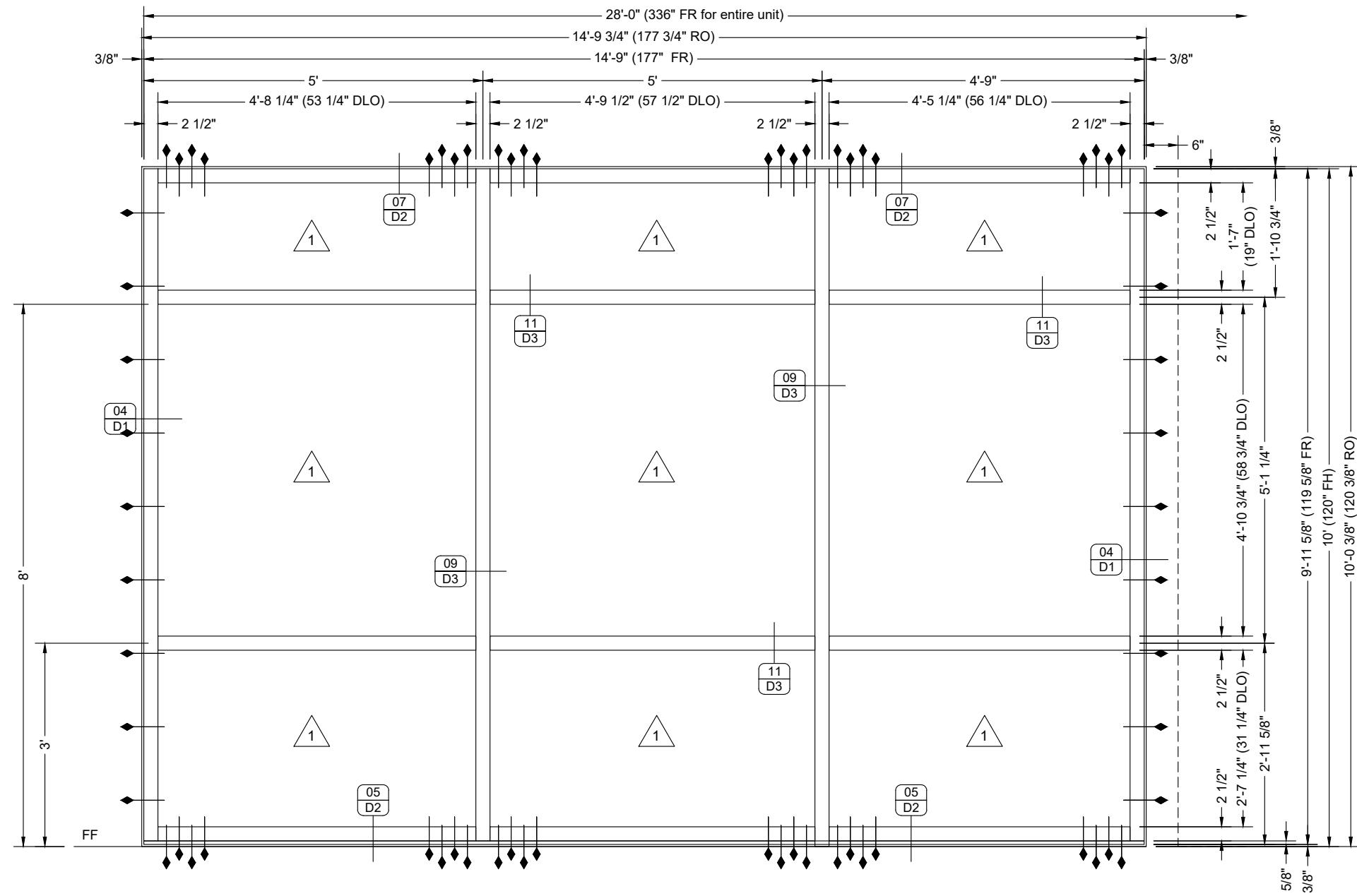

**ELEVATION**

QUANTITY: 01  
 SCALE: 1/2" = 1'-0"  
 ARCH REF: 1/A101  
 6/A502  
 3/A601 18/A602 10/A701



**EXT STOREFRONT**

YKK YHS 50-FI IMPACT ALUMINUM STOREFRONT

DATE	DESCRIPTION
06/20/22	First Submittal
fp	BY
1	SUB

**EVINS GLASS SERVICE, INC**  
 101 N.P.I.D., CORPUS CHRISTI, TX 78406  
 WORK (361) 884-3995 FAX (361) 884-4262

PROJECT: SECURITY SERVICE FEDERAL CREDIT UNION  
**NEW BUILDING WITH TENANT SPACES**  
 ARCHITECT: LUNA MIDDLEMAN ARCHITECTS  
 (210) 346-2400  
 GENERAL CONTRACTOR: JORDAN FOSTER CONSTRUCTION  
 (210) 375-1280

PROJECT NO.	EGS-2206-01
DRAWN BY	fp
DATE	06/20/22
SCALE	1/2" = 1'-0"
DRAWING	ELEVATIONS
SHEET	E8

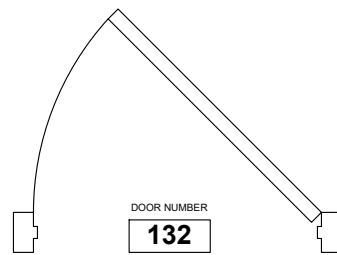
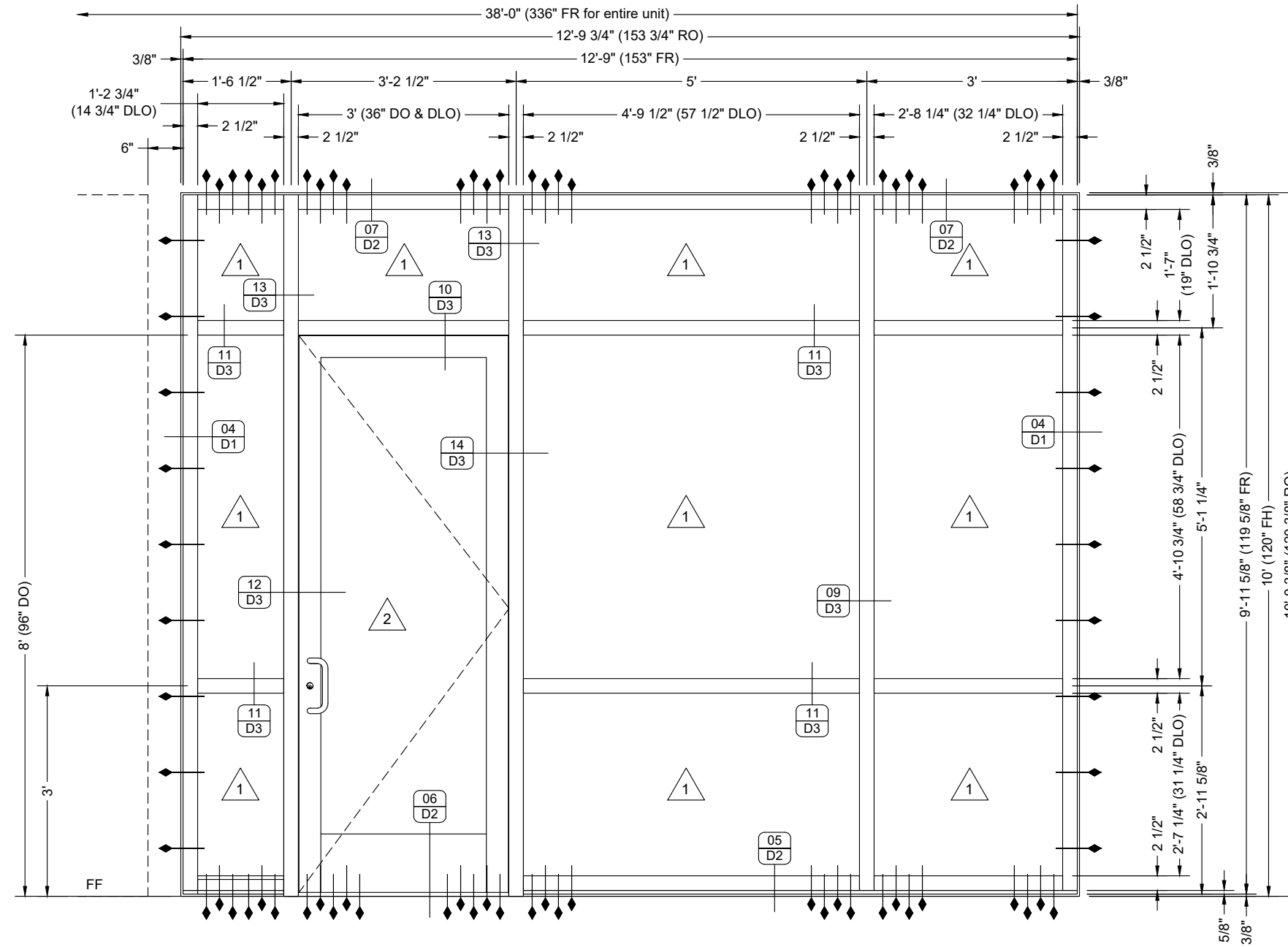

**DOOR HARDWARE**

- YKK H-6104 Standard Surface Mounted Closer
- YKK P-1300 Standard 4 1/2" x 4" Butt Hinges
- YKK P-52497 Standard Concealed Vertical Rod Panic Exit Device
- YKK H-1341/1541/1542 Standard Smart Series Entrance Handles
- YKK H-7107 10" Bottom Rail Weatherstrip with Gasket and Door Sweep
- YKK H-8101/8201/8301 Series Standard 1/2" x 4" Thresholds
- DUAL Horton 7100 Commercial Series Auto Operators (power by others)

**ELEVATION**

QUANTITY: 01  
 SCALE: 1/2" = 1'-0"  
 ARCH REF: 1/A101  
 6/A502  
 3/A601 18/A602 10/A701



**EXT STOREFRONT**

YKK YHS 50-FI IMPACT ALUMINUM STOREFRONT  
 YKK 35H MEDIUM STILE IMPACT DOORS

NO.	SUB	BY	DATE	DESCRIPTION
1		fp	06/20/22	First Submittal

**EVINS GLASS SERVICE, INC**  
 101 N.P.I.D., CORPUS CHRISTI, TX 78406  
 WORK (361) 884-3995 FAX (361) 884-4262

PROJECT SECURITY SERVICE FEDERAL CREDIT UNION  
**NEW BUILDING WITH TENANT SPACES**  
 ARCHITECT LUNA MIDDLEMAN ARCHITECTS  
 (210) 340-2400  
 GENERAL CONTRACTOR JORDAN FOSTER CONSTRUCTION  
 (210) 375-1280

PROJECT NO. EGS-2206-01	
DRAWN BY fp	DATE 06/20/22
SCALE 1/2" = 1'-0"	
DRAWING ELEVATIONS	
SHEET E9	

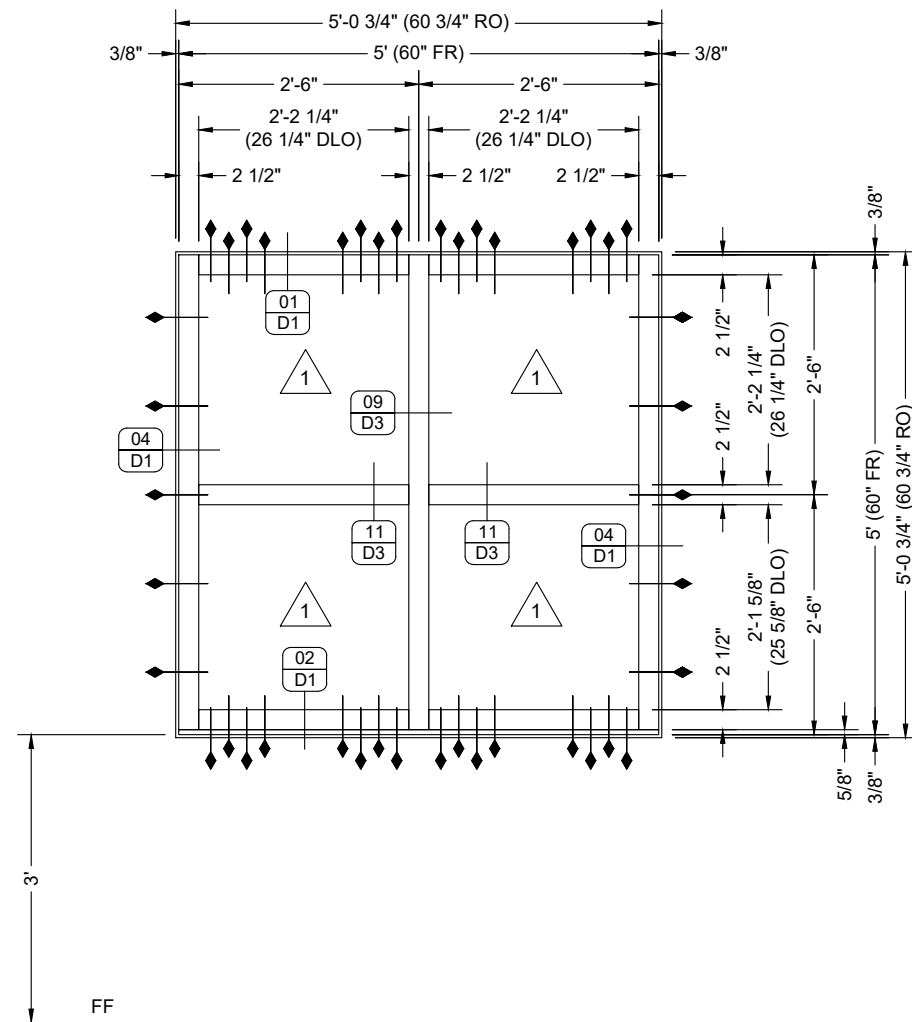

**ELEVATION**

QUANTITY: 01  
 SCALE: 1/2" = 1'-0"  
 ARCH REF: 1/A101  
 3/A210 5/A210



**EXT STOREFRONT**

YKK YHS 50-FI IMPACT ALUMINUM STOREFRONT  
 1/A502 3/A601 10/A602 11/A602 12/A602

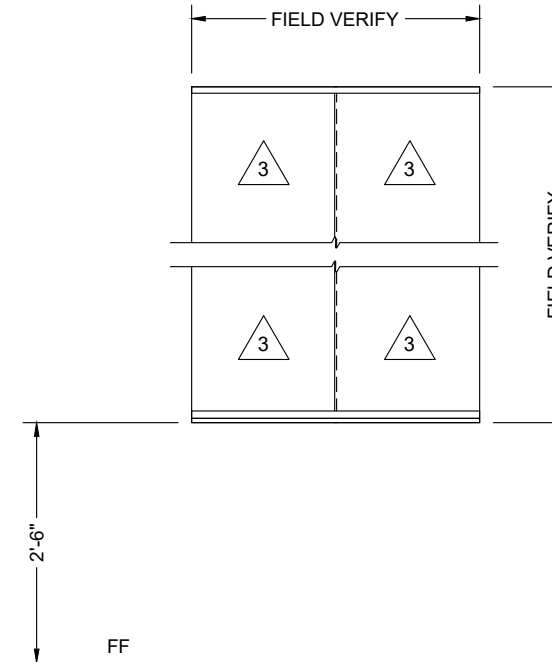

**ELEVATION**

QUANTITY: 01  
 SCALE: 1/2" = 1'-0"  
 ARCH REF: 1/A101  
 11/A111 1/A210



**TRANSACTION WINDOW**

CR LAURENCE SERIES D2730 TRANSACTION WINDOW

NO.	DATE	DESCRIPTION
1	06/20/22	First Submittal

**EVINS GLASS SERVICE, INC**  
 101 N.P.I.D., CORPUS CHRISTI, TX 78406  
 WORK (361) 884-3995 FAX (361) 884-4262

PROJECT: SECURITY SERVICE FEDERAL CREDIT UNION  
**NEW BUILDING WITH TENANT SPACES**  
 ARCHITECT: LUNA MIDDLEMAN ARCHITECTS  
 (210) 346-2400  
 GENERAL CONTRACTOR: JORDAN FOSTER CONSTRUCTION  
 (210) 375-1280

PROJECT NO.	EGS-2206-01
DRAWN BY	fp
DATE	06/20/22
SCALE	1/2" = 1'-0"
DRAWING	ELEVATIONS
SHEET	E10

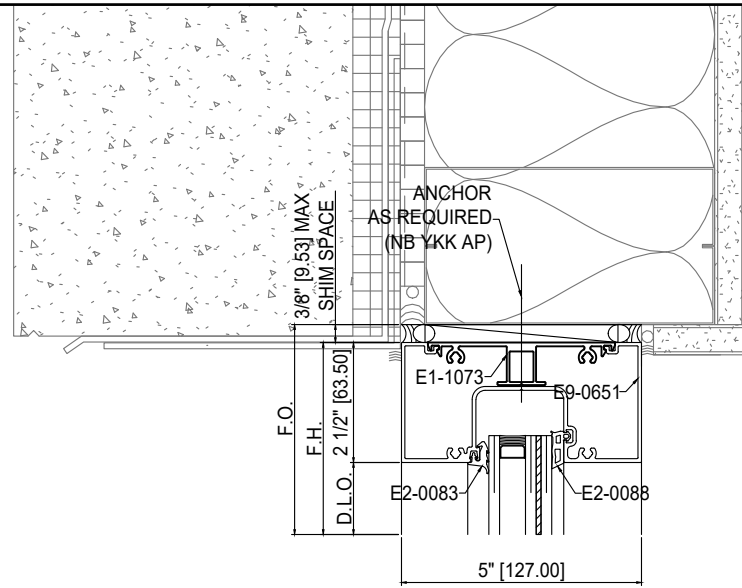

**DETAIL 01 EXT HEAD**  
 SCALE: 3" = 1'-0"  
 ARCH REF: 10/A602  
**YKK YHS 50-FI ALUMINUM STOREFRONT**

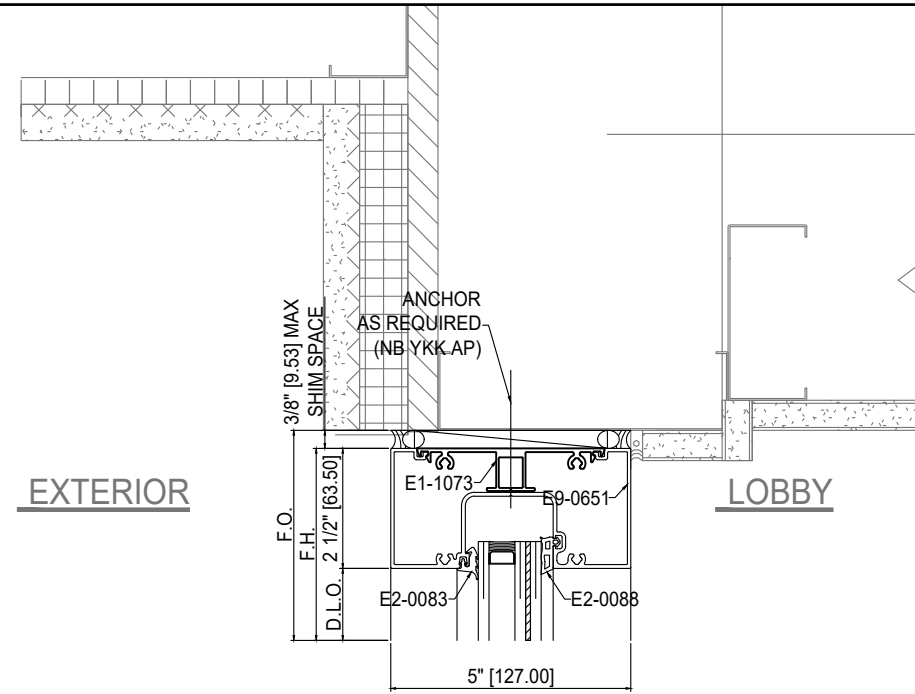

**DETAIL 03 EXT HEAD**  
 SCALE: 3" = 1'-0"  
 ARCH REF: 13/A602  
**YKK YHS 50-FI ALUMINUM STOREFRONT**

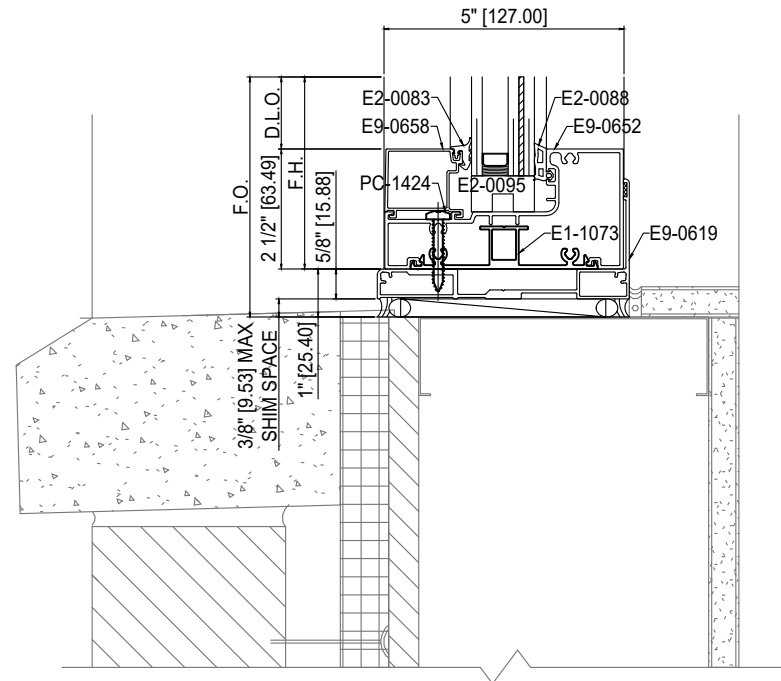

**DETAIL 02 EXT SILL**  
 SCALE: 3" = 1'-0"  
 ARCH REF: 11/A602  
**YKK YHS 50-FI ALUMINUM STOREFRONT**

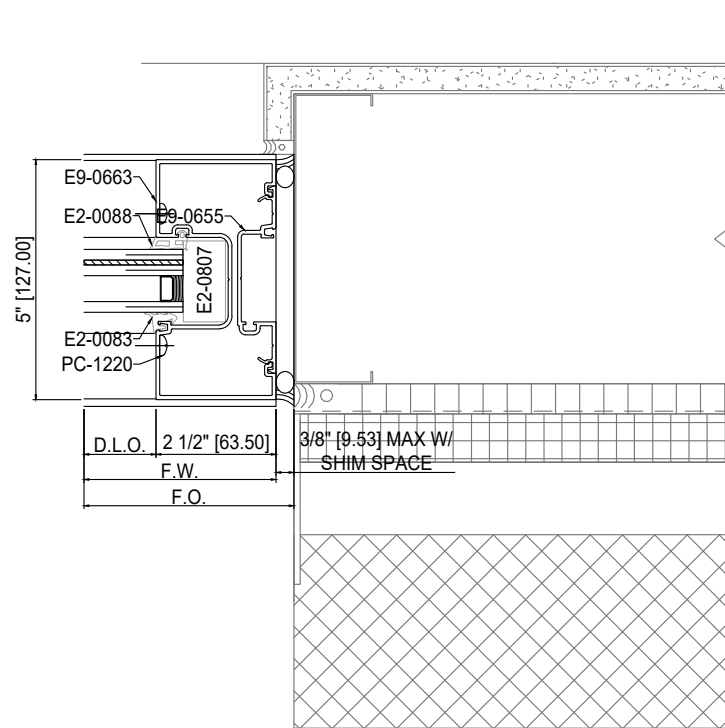

**DETAIL 04 EXT JAMB**  
 SCALE: 3" = 1'-0"  
 ARCH REF: 12/A602  
**YKK YHS 50-FI ALUMINUM STOREFRONT**

NO.	DATE	DESCRIPTION
1	06/20/22	First Submittal
fp		BY
1		SUB

**EVINS GLASS SERVICE, INC**  
 101 N.P.I.D., CORPUS CHRISTI, TX 78406  
 WORK (361) 884-3995 FAX (361) 884-4262

PROJECT SECURITY SERVICE FEDERAL CREDIT UNION  
**NEW BUILDING WITH TENANT SPACES**  
 ARCHITECT LUNA MIDDLEMAN ARCHITECTS  
 (210) 340-2400  
 GENERAL CONTRACTOR JORDAN FOSTER CONSTRUCTION  
 (210) 375-1280

PROJECT NO.	EGS-2206-01
DRAWN BY	fp
DATE	06/20/22
SCALE	3" = 1'-0"
DRAWING	DETAILS
SHEET	D1